

1924 Portland Tax Records: 116 Monument Street, Portland, 1924

Portland, Maine
 Assessment 19
 Name **Ventresca Filomena**
 Owner **Ventresca Filomena**
 Street **Monument** No. **116**
 Block **17C** Lot **81**
 Use of Bldg. **Residential** Name
 Tenants and Rooms **1 Tenant's**
 Rentals **20**
 Age **40+**
 Condition of Repair **Fair**

- | | | |
|---------------------|-----------------|-----------------------|
| Class | Exterior | Plumbing |
| Bungalow | Clapboards | Common |
| Single House | Siding | Individual |
| Two family | Shingles | Open |
| Three family | Stucco | Set tubs |
| Apartment | Paper | Finish |
| Store Building | Tapestry Brick | Plain |
| Office | Com. Brick | Hardwood |
| Factory | Galv. Iron | Halls |
| Storage | Stone | Wood |
| Stables | Terra Cotta | Terrazzo |
| Garage, private | Concrete | Marble |
| Garage, public | | |
| Theatre | Heating | Roof - Roofing |
| Club House | Stove | Shingle |
| Cottage | Furnace | Slate |
| | Hot Water | Gravel |
| | Steam | Prepared |
| Foundation | Light | Asbestos |
| Brick | Oil | Flat |
| Stone | Gas | Hip |
| Concrete | Electric | Gable |
| Pile | | Dormers |
| Basement | Floor | Windows |
| Full | Common | Plain Glass |
| Cement Floor | Hardwood | Wire Glass |
| Waterproof | Re-Concrete | Shutters |
| Construction | Concrete Slab | Miscellaneous |
| Frame | Waterproof | Elevator |
| Brick | | Sprinkler |
| Tile | Ceiling | Fire Escape |
| Blocks | Plaster | Refrigerator |
| Stucco | Metal | Vacuum Cleaner |
| Re-Concrete | Panelled | Safes and Vaults |
| Mill | Rough | Telephone Equip. |
| Steel Frame | | |

Ground Area **811.25** Height **24'**
 Cubic Feet **19,470** Unit **18** cts.
 Utility Dep. **50** Per cent.
 Dep. **50** Per cent.
Sound Value, \$ 1752

Land **2449** Corner Interior Alley
 Front Depth = ft.
 COMPUTATION

Area	Multiplier	Coefficient	
2449	108	2644	
Year	Unit	Coefficient	Land Value
19	212	2644	(317) X



Surveyed by **D. B. Blawie**
 APR 18 1924
 (Remarks on other Side)
 '25 - 1186/316 - 5500 +

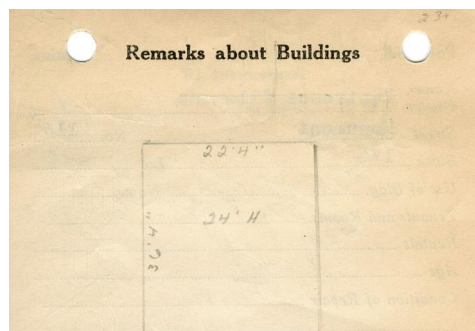

$22'4" \times 36'4" = 811.25 \times 24 = 19,470$

Remarks about Land

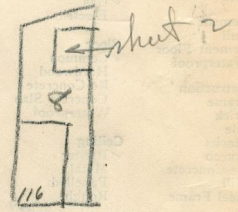

MONUMENT ST.

36.33
 22.33
 108.99
 108.99
 7266
 7266
 811.2589
 24

Remarks about Personal Property

324500
 1622500
 19470.00

CITY OF PORTLAND, MAINE
 ASSESSORS DEPARTMENT

CHART	BLOCK
3	Building Volumes Checked Mr. B.
4	Building Values Placed PE.2
5	Building Values Extended
6	Land Only Questionnaire Made
7	Land Values Placed
8	Land Values Extended
9	Compared with 1923
10	Personal Property Added

1924 Portland Tax Records: 116 Monument Street, Portland, 1924



Owner: Filomena Ventresca
Address: 116 Monument Street, East End - Munjoy Hill, Portland, Maine
Use: Dwelling - Two family
Local Code: Block 17G Lot 8 Book 52 Page 1
MMN item number: 64082
Notes: The property was subsequently owned by Alfred Herman.