

1924 Portland Tax Records: 343-349 Forest Avenue, Portland, 1924

Portland, Maine  
 Assessment 19  
 Name  
 Owner Mank Miles B. Motor Car Co.  
 Street Forest Ave. No 343-349  
 Block Oakleigh Rd Lot 4  
 Use of Bldg. Garage + Main Name  
 Tenants and Rooms 1-5 rooms + 2 toilets  
 Rentals to be obtained later  
 Age 1916 + 17  
 Condition of Repair Good

- |                     |                 |                       |
|---------------------|-----------------|-----------------------|
| <b>Class</b>        | <b>Exterior</b> | <b>Plumbing</b>       |
| Bungalow            | Clapboards      | Common                |
| Single House        | Siding          | Individual            |
| Two family          | Shingles        | Open                  |
| Three family        | Stucco          | Set tubs              |
| Apartment           | Paper           |                       |
| Store Building      | Tapestry Brick  | <b>Finish</b>         |
| Office              | Com. Brick      | Plain                 |
| Factory             | Galv. Iron      | Hardwood              |
| Storage             | Stone           |                       |
| Stables, private    | Terra Cotta     | <b>Halls</b>          |
| Garage, public      | Concrete        | Wood                  |
| Theatre             |                 | Terrazzo              |
| Club House          |                 | Marble                |
| Cottage             |                 |                       |
|                     | <b>Heating</b>  | <b>Roof - Roofing</b> |
|                     | Stove           | Shingle               |
|                     | Furnace         | Slate                 |
|                     | Hot Water       | Gravel                |
|                     | Steam           | Prepared              |
| <b>Foundation</b>   |                 | Asbestos              |
| Brick               |                 | Flat                  |
| Stone               | <b>Light</b>    | Hip                   |
| Concrete            | Oil             | Gable                 |
| Pile                | Gas             | Dormers               |
|                     | Electric        |                       |
| <b>Basement</b>     |                 | <b>Windows</b>        |
| Full                |                 | Plain Glass           |
| Cement Floor        | <b>Floor</b>    | Wire Glass            |
| Waterproof          | Common          | Shutters              |
|                     | Hardwood        |                       |
| <b>Construction</b> | Re-Concrete     | <b>Miscellaneous</b>  |
| Frame               | Concrete Slab   | Elevator              |
| Brick               | Waterproof      | Sprinkler             |
| Tile                |                 | Fire Escape           |
| Blocks              | <b>Ceiling</b>  | Refrigerator          |
| Stucco              | Plaster         | Vacuum Cleaner        |
| Re-Concrete         | Metal           | Safes and Vaults      |
| Mill                | Panelled        | Telephone Equip.      |
| Steel Frame         | Rough           |                       |

Ground Area 11481 sq ft Height 30'  
 Cubic Feet 360402 Unit 17600 cts  
 Utility Dep.  
 Dep. 30 Per cent.  
 Sound Value, \$ 38809 with 3

Land 17600 Corner Interior Alley  
 Front Depth = ft.  
 COMPUTATION  
 $10,000 \times 100 \times .75 = 7500$   
 $10,000 \times .45 = 4500$   
 $7500 \times 100 \times .15 = 1125$   
9000

Area	Multiplier	Coefficient	
	R		
Year	Unit	Coefficient	Land Value
19			<u>\$9000</u>



Surveyed by J. H. B. 100  
 (Remarks on other Side) June 5, 1924  
 10/3

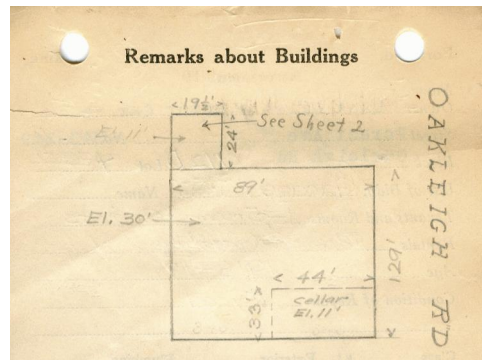

343-349 FOREST AVE  
 44 x 33 x 11 = 15972  
 89 x 129 = 11481 # x 30 = 344430  
360402

Remarks about Land  
 Hollow tile-plaster partitions

Remarks about Personal Property

436 - 0350  
 11481

ACCESSORS DEPARTMENT

CHART	CLOCK
3 Building Volume Checked	
4 Building Values Placed	dc
5 Building Values Extended	
6 Land Only Questionnaire Made	100
7 Land Values Placed	
8 Land Values Extended	
9 Compared with 1923	
10 Personal Property Added	

1924 Portland Tax Records: 343-349 Forest Avenue, Portland, 1924

[www.mainememory.net/item/54511](http://www.mainememory.net/item/54511)  
Collections of City of Portland - Planning & Development



**Owner:** Miles B. Mank Motor Car Company  
**Address:** 343-349 Forest Avenue, Oakdale, Portland, Maine  
**Use:** Garage - Showroom  
**Local Code:** Block 112D Lot 4 Book 35 Page 1  
**MMN item number:** 54511