

1924 Portland Tax Records: 271 Deering Avenue, Portland, 1924

Portland, Maine  
 Assessment 19  
 Name Wilkie Hardy  
 Street Deering Ave No. 271  
 Block 117-A Lot 19  
 Use of Bldg. 7 Name  
 Tenants and Rooms 1 - owner - 2  
 Rentals owner  
 Age 8-10  
 Condition of Repair good

- |                     |                 |                       |
|---------------------|-----------------|-----------------------|
| <b>Class</b>        | <b>Exterior</b> | <b>Plumbing</b>       |
| Bungalow            | Clapboards      | Common                |
| Single House        | Siding          | Individual            |
| Two family          | Shingles        | Open                  |
| Three family        | Stucco          | Set tubs              |
| Apartment           | Paper           | <b>Finish</b>         |
| Store Building      | Tapestry Brick  | Plain                 |
| Office              | Com. Brick      | Hardwood              |
| Factory             | Galv. Iron      | <b>Halls</b>          |
| Storage             | Stone           | Wood                  |
| Stables             | Terra Cotta     | Terrazzo              |
| Garage, private     | Concrete        | Marble                |
| Garage, public      |                 |                       |
| Theatre             | <b>Heating</b>  | <b>Roof - Roofing</b> |
| Club House          | Stove           | Shingle               |
| Cottage             | Furnace         | Slate                 |
|                     | Hot Water       | Gravel                |
| <b>Foundation</b>   | Steam           | Prepared              |
| Brick               |                 | Asbestos              |
| Stone               | <b>Light</b>    | Flat                  |
| Concrete            | Oil             | Hip                   |
| Pile                | Gas             | Gable                 |
|                     | Electric        | Dormers               |
| <b>Basement</b>     |                 | <b>Windows</b>        |
| Full                |                 | Plain Glass           |
| Cement Floor        | <b>Floor</b>    | Wire Glass            |
| Waterproof          | Common          | Shutters              |
|                     | Hardwood        | <b>Miscellaneous</b>  |
| <b>Construction</b> | Re-Concrete     | Elevator              |
| Frame               | Concrete Slab   | Sprinkler             |
| Brick               | Waterproof      | Fire Escape           |
| Tile                |                 | Refrigerator          |
| Blocks              | <b>Ceiling</b>  | Vacuum Cleaner        |
| Stucco              | Plaster         | Safes and Vaults      |
| Re-Concrete         | Metal           | Telephone Equip.      |
| Mill                | Panelled        |                       |
| Steel Frame         | Rough           |                       |

Ground Area 1747 Height 25-9  
 Cubic Feet 40907 Unit 20 cts.  
 Utility Dep.  
 Dep. 40 Per cent.  
**Sound Value, \$ 5400**

Land 6623 Corner Interior Alley  
 Front Depth = ft.

COMPUTATION  
 $6623 \times 100 \times .20 = 1324$   
 $6623 \times .20 = 165$   
 $1324 + 165 = 1489$

Area	Multiplier	Coefficient	
<u>1747</u>			
Year	Unit	Coefficient	Land Value
19			<u>\$1489</u>



Surveyed by [Signature]  
 JUN 4 - 1924  
 (Remarks on other Side)

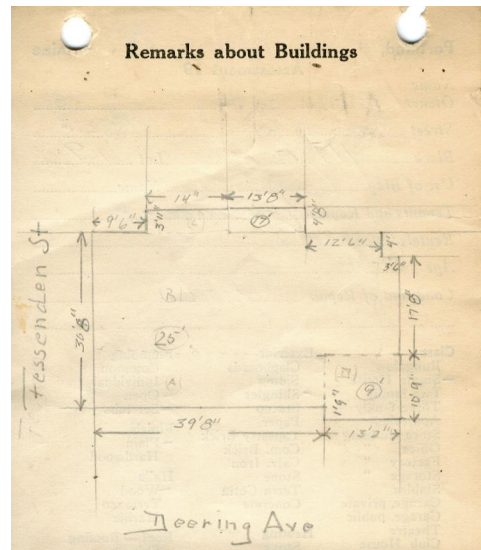

Remarks about Land

$39.66 \times 9 = 357 \times 25 = 8925$   
 $21.66 \times 5.83 = 1144 - 3.5 \times 4 = 1120$   
 $+ 25 = 28250$   
 $3.91 \times 14 = 55 + 25 = 1375$   
 $13.16 \times 12.75 = 141 + 9 = 1269$   
 $13.66 \times 4.66 = 64 + 17 = 1081$   
**1747 40907**

Remarks about Personal Property

CITY OF PORTLAND, MAINE  
 ASSESSORS DEPARTMENT

CHART	BLOCK
3 Building Volumes Checked	<u>dc</u>
4 Building Values Placed	
5 Building Values Extended	<u>C. W. M. S.</u>
6 Land Only Questionnaire Made	
7 Land Values Placed	
8 Land Values Extended	
9 Compared with 1923	
10 Personal Property Added	

1924 Portland Tax Records: 271 Deering Avenue, Portland, 1924

[www.maine-memory.net/item/49229](http://www.maine-memory.net/item/49229)  
Collections of City of Portland - Planning & Development



**Owner:** Harry Wilkie  
**Address:** 271 Deering Avenue, Oakdale, Portland, Maine  
**Use:** Dwelling - Single family  
**Local Code:** Block 117A Lot 19 Book 28 Page 1  
**MMN item number:** 49229