

RANGE 13	LOT 7	OWNER <i>Paul V. Marguinite Davis</i> Dr. Re	V. Davis)	ADDRESS Main St. Bridgton, Me. 631
--------------------	-----------------	--	-----------	--

TOWN OF BRIDGTON, MAINE		
ASSESSORS' DEPARTMENT		
LAND		
Frontage 61-60	Depth 154-154	Area 9248
COMPUTATIONS		
Area	Unit	Value
LAND VALUE		
BUILDING VALUE <i>Main House 891 sq ft x \$25 = \$22,275</i>		
<i>Extension 836 " " x \$12.5 = \$10,450.00</i>		
<i>Barn 408 " " x \$1.00 = \$408.00</i>		
<i>Barn 416 " " x \$1.00 = \$416.00</i>		
<i>Covered Porch 608 " " x .75 = \$456.00</i>		
<i>Buildings 2460.00</i>		
<i>Covered Porch 100 " " x .75 = \$75.00</i>		
<i>Replacement - 7035.75</i>		
<i>Depreciation 30% 2110.73</i>		
<i>\$925.00</i>		
<i>Tax value 2462.51</i>		

BUILDING			
Class	Construction	Roof	Floors
House	Frame <input checked="" type="checkbox"/>	Flat	Common
Single <input checked="" type="checkbox"/>	Brick	Hip	Hardwood <input checked="" type="checkbox"/>
Double	Tile	Gable <input checked="" type="checkbox"/>	Composition
Apartment	Block		Tile
Store	Mill		Conc. Slabs
Office	Steel Frame		Re-Conc.
Hotel		Roofing	
Factory	Ext'r Walls	Shingle <input checked="" type="checkbox"/>	
Warehouse	Clap. <input checked="" type="checkbox"/>	Slate	
Barn <input checked="" type="checkbox"/>	Siding	Tile	
Garage	Shingle	Gravel	
	Stucco	Paper	
	Paper	Iron	
	Com. Brick	Asbestos <input checked="" type="checkbox"/>	
	Stone		
	Concrete	Heating	
	Post	Insulation	Fireplace <input checked="" type="checkbox"/>
			Stove
			Hot Air
			Hot Water
			Steam <input checked="" type="checkbox"/>
			Oil Burner
			Mech. Stoker
			Plumbing
			Water Sys. CITY
			Sink <input checked="" type="checkbox"/>
			Closet <input checked="" type="checkbox"/>
			Hot Water
			Bath <input checked="" type="checkbox"/>
			Set Tub <input checked="" type="checkbox"/> double
			Cesspool
			Septic T.
			Brook
Foundation	Lighting	Partition	
Stone <input checked="" type="checkbox"/>	Elec. <input checked="" type="checkbox"/>	Plaster <input checked="" type="checkbox"/>	
Brick	Lamps	Wall'd	
Concrete	Home Sys.		
Post			
Basement			
M.H.			
CEMENT FT.			
Rooms	1 2 3 4 5		
	5 4 0		
	Road - Dirt <input type="checkbox"/> Gravel <input type="checkbox"/> Surfaced <input checked="" type="checkbox"/>		
Refrig.	Sprinkler		
Elevator	Fire Escape		

DESCRIPTION OF PROPERTY

Warranty deed from Elizabeth M. Newcomb to Nathaniel R. Mason.

A certain lot of land situated in said town of Bridgton, part of lot seven (7) in the thirteenth (13) range of lots at said town and bounded as follows, to wit: Beginning on the northerly side of the road leading by the Methodist Meeting House at a point on said lot twenty (20) feet easterly of the easterly corner of the filed in front of the dwelling house, now or formerly of George W. Freeman, running northerly on a line parallel with the line of Elkanah A. Littlefield's house lot, about eight (8) rods to a stone wall, thence easterly by a stone wall to said Elkanah A. Littlefield's house lot, about sixty (60) feet; thence southerly by the line of said Elkanah A. Littlefield's house lot to said road about eight rods; thence westerly by said road sixty (60) feet to the place of beginning. And I also hereby convey to said Nathaniel R. Mason one half undivided half of a strip of land twenty (20) feet wide situated on the west side of the lot above described to be used by him or his assigns in common as a road or passage way with Almon F. Hill, His heirs or assigns, and for no other purpose whatever. Being the same premises conveyed by George W. Newcomb to me by deed dated August 15, 1911, and recorded in Cumberland County Registry of Deeds, Book 945, Page 27, to which deed and record thereof, reference is hereby made and made a part thereof, for a more particular description of the premises hereby conveyed. A certain lot of

BOOK 1476 PAGE 174 July 31, 1935

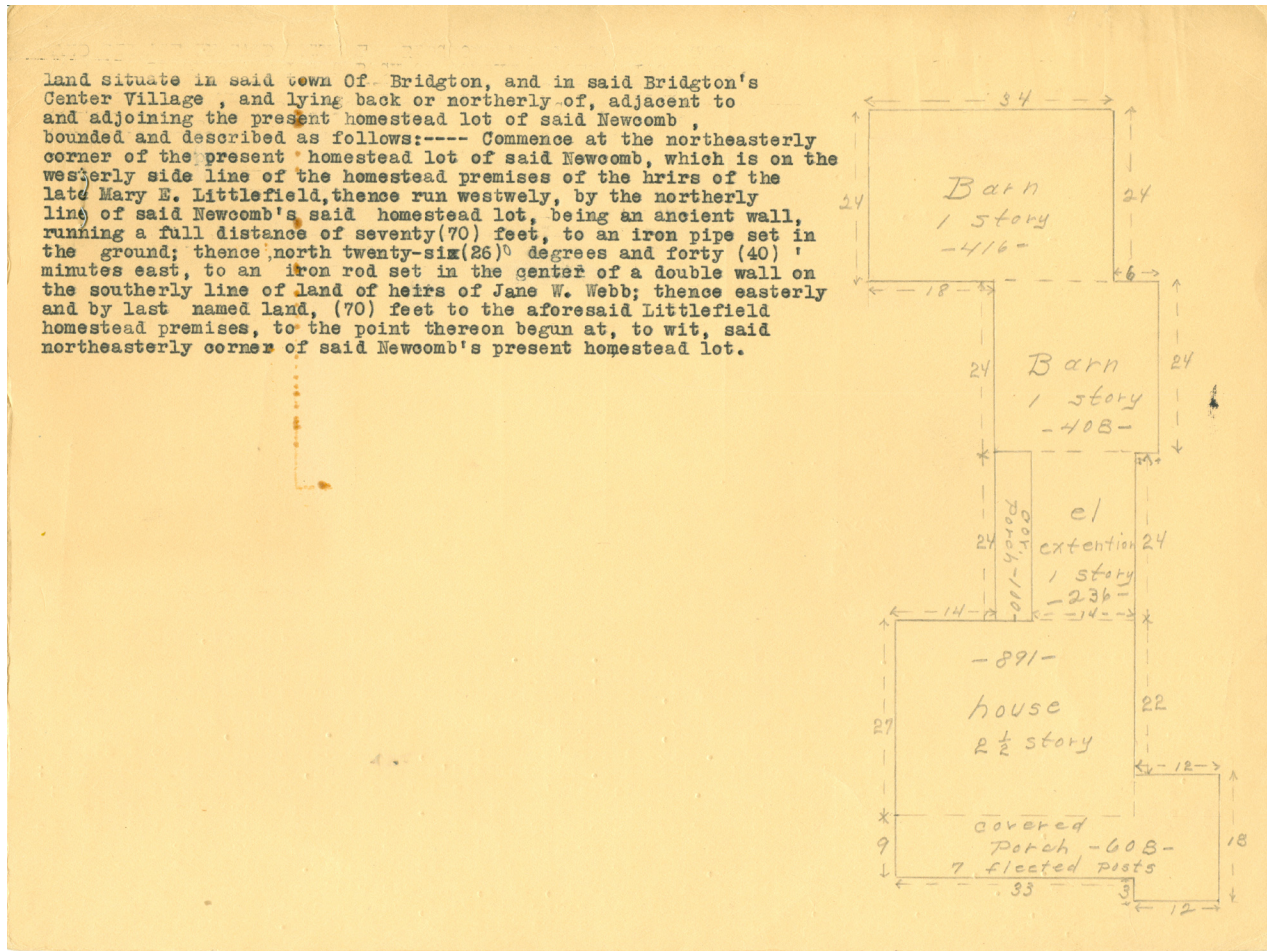



Contributed to Maine Memory Network by Bridgton Historical Society

MMN # 98991

Date: 1930s Bridgton Tax Records

Location: Main Street, Bridgton

Owner: Robert Mason

Use: Single family house