

RANGE 13	LOT 7	OWNER <i>Charles Thompson</i>	ADDRESS 1-3 Main Street, Bridgton, Maine.
-------------	----------	----------------------------------	--

556

TOWN OF BRIDGTON, MAINE
ASSESSORS' DEPARTMENT

LAND		
Frontage	Depth	Area
80-83	42-60	4224

COMPUTATIONS		
Area	Unit	Value
LAND VALUE		
BUILDING VALUE		
TOTAL		

TOTAL GARAGE SPACE
3472 sq ft x 1.10 = 3819.20
HOUSE 963 sq ft x 4.10 = 3948.30
308 DEC 2255.00
21322.33
VAL. 2696.00

BUILDING

Class	Construction	Roof	Floors
House <input checked="" type="checkbox"/>	Frame <input checked="" type="checkbox"/>	Flat	Common 6
Single <input checked="" type="checkbox"/>	Brick	Hip	Hardwood
Double	Tile	Gable <input checked="" type="checkbox"/>	Composition
Apartment	Block		Tile
Store	Mill		Conc. Slabs
Office	Steel Frame		Re-Conc.
Hotel		Roofing	
Factory	Ext'r Walls	Shingle <input checked="" type="checkbox"/>	
Warehouse	Clap. <input checked="" type="checkbox"/>	Slate	Heating
Barn	Siding	Tile	Fireplace
Garage <input checked="" type="checkbox"/>	Shingle	Gravel	Stove
	Stucco	Paper	Hot Air
	Paper	Iron	Hot Water
	Com. Brick	Asbestos	Steam <input checked="" type="checkbox"/>
	Stone		Oil Burner
	Insulation		Mech. Stoker
Foundation		Partition	
Stone <input checked="" type="checkbox"/>		Plaster	Plumbing
Brick		Wall'b'd	Water Sys. city
Concrete <input checked="" type="checkbox"/>		sheet	Sink 1
Post		rock	Closet
	Lighting		Hot Water
	Elec. <input checked="" type="checkbox"/>		Bath 1
	Lamps		Set Tub
	Home Sys.		Cesspool
Basement			Septic T.
1-RM Dirt			Street
Floor			Sewer.
Rooms			
Gar. 1 2 3 4 5			
Road - Dirt <input type="checkbox"/> Gravel <input type="checkbox"/> Surfaced <input checked="" type="checkbox"/>			
Refrig. <input type="checkbox"/>	Sprinkler <input type="checkbox"/>		
Elevator <input type="checkbox"/>	Fire Escape <input type="checkbox"/>		



DESCRIPTION OF PROPERTY BOOK 1239 PAGE 8 June 10, 1926

Shingles poor, Paint poor.
 1 Main Street. Mr. Charles E. Thompson bounded as follows:- Northerly by Main Street, so called,
 Westerly by Gage Street; Southerly by the Engine House Lot and Easterly by store lot formerly
 owned by Holman S. Melcher and now occupied by Stiles and Fitton Co., The above real estate is
 all and the same conveyed to us by Frank A. Webb by his deed dated Sept. 21, 1923 and Recorded
 in Cumberland Registry of Deeds, Book 1149, Page 76.....

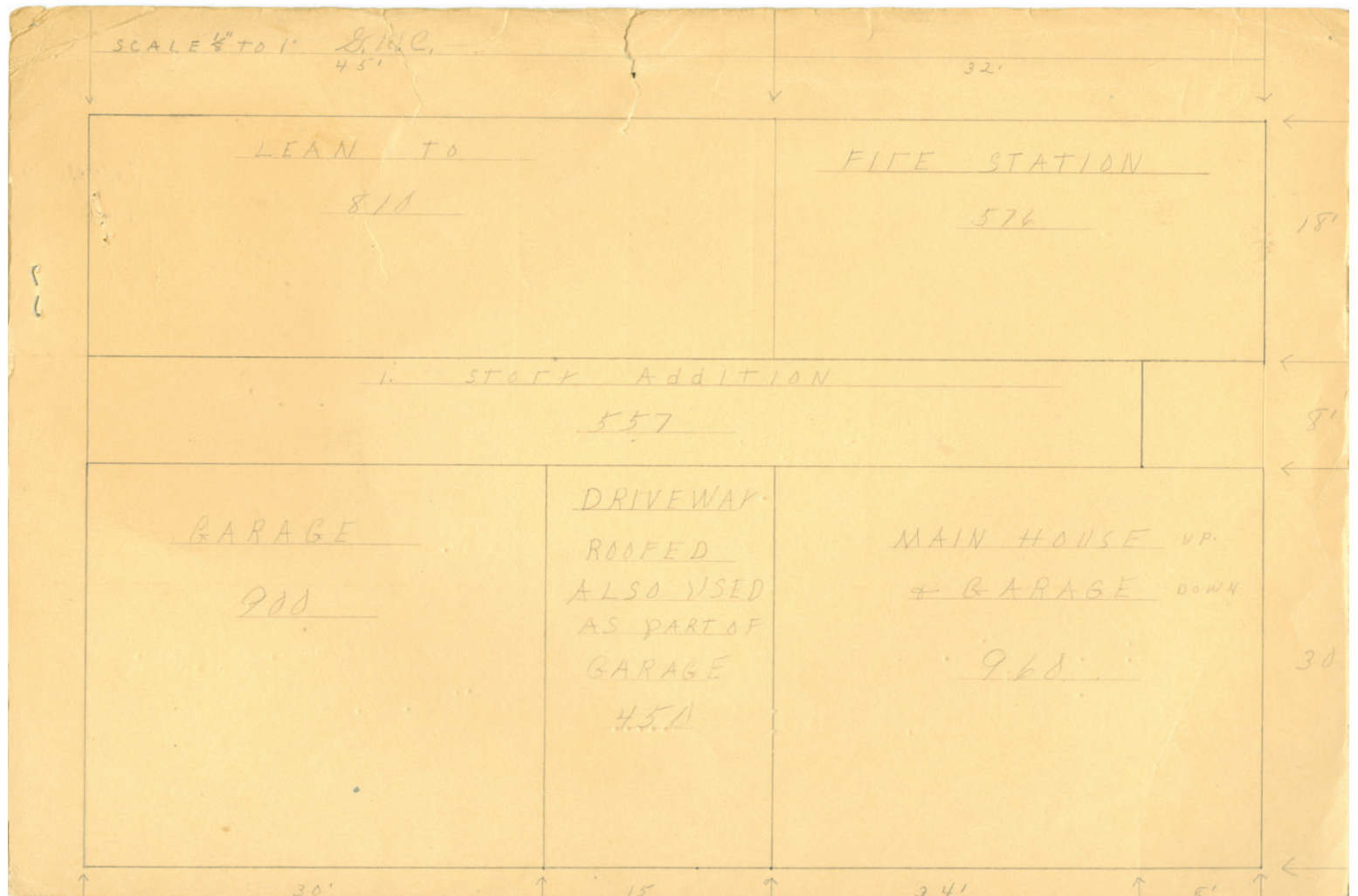



Contributed to Maine Memory Network by Bridgton Historical Society

MMN # 79626

Date: 1930s Bridgton Tax Records

Location: Charles E. Thompson Esso Station on Main Street Bridgton

Use: Commercial building owned by Charles E. Thompson