

| | | | | |
|-------|-----|---|---|------|
| RANGE | LOT | OWNER <i>Harrison D. Rust Jr</i> <i>Mrs Anna Kinsley</i> | ADDRESS <i>Sweden Rd.</i> <i>Bridgton, Me.</i> | 1286 |
|-------|-----|---|---|------|

| | | |
|--------------------------------|-------|-------|
| TOWN OF BRIDGTON, MAINE | | |
| ASSESSORS' DEPARTMENT | | |
| LAND | | |
| Frontage | Depth | Area |
| COMPUTATIONS | | |
| Area | Unit | Value |
| LAND VALUE | | |
| BUILDING VALUE | | |
| TOTAL | | |

| | | | | |
|-----------------|--------------|------------|------------------|---|
| BUILDING | | | | |
| Class | Construction | Roof | Floors | |
| House | Frame X | Flat | Common | X |
| Single X | Brick | Hip | Hardwood | |
| Double | Tile | Gable X | Composition | |
| Apartment | Block | | Tile | |
| Store | Mill | | Conc. Slabs | |
| Office | Steel Frame | | Re-Conc. | |
| Hotel | | | | |
| Factory | Ext'r Walls | Shingle | Heating | |
| Warehouse | Clap. | Slate | Fireplace | |
| Barn | Shingle X | Tile | Stove X | |
| Garage | Stucco | Gravel | Hot Air | |
| | Paper | Paper | Hot Water | |
| | Foundation | Iron | Beam | |
| Stone | Stone | Asphlt | Oil Burner | |
| Brick | Com. Brick | asphalt s. | Mech. Stoker | |
| Concrete | Stone | | | |
| | Insulation | | Plumbing | |
| | Lighting | | Water Sys-el. p. | |
| | Elec. X | | Sink 1 | |
| | Lamps | | Closet 1 | |
| | Home Sys. | | Hot Water | |
| | | | Bath | |
| | | | Set Tub | |
| | | | Cesspool | |
| | | | Septic T. 1 | |
| Rooms | 1 2 3 4 5 | | | |
| | 1 | | | |
| Road - Dirt X | Gravel | Surfaced | | |
| Refrig. | Sprinkler | | | |
| Elevator | Fire Escape | | | |

DESCRIPTION OF PROPERTY
1 story camp good condition.

BOOK PAGE

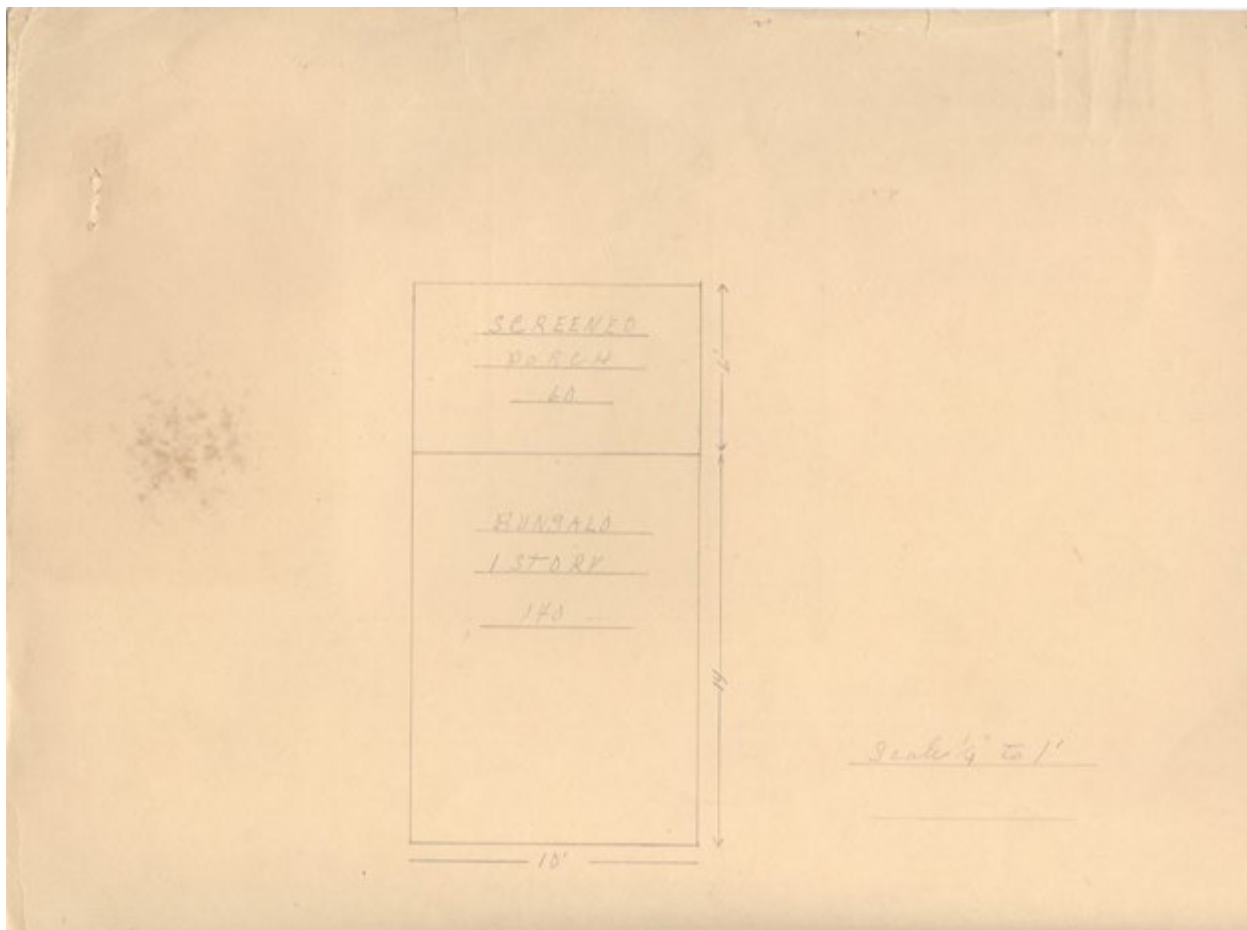



Contributed to Maine Memory Network by Bridgton Historical Society

MMN # 103426
Date: 1930s Bridgton Tax Records
Location: 19 Sweden Rd, Bridgton, ca. 1938
Owner: Emma Kanaly
Use: Residential