

RANGE 4-C	LOT 3	OWNER <i>Charnice</i> Clayton L. Ames & J. Belle Ames	ADDRESS West Bridgton, Me.	2686
--------------	----------	---	-------------------------------	------

TOWN OF BRIDGTON, MAINE ASSESSORS' DEPARTMENT		
LAND		
Frontage	Depth	Area
COMPUTATIONS		
Area	Unit	Value
LAND VALUE		
BUILDING VALUE		
TOTAL		
DESCRIPTION OF PROPERTY		

BUILDING			
Class	Construction	Roof	Floors
House	Frame X	Flat	Common X
Single X	Brick	Hip	Hardwood
Double	Tile	Gable X	Composition
Apartment	Block		Tile
Store	Mill		Conc. Slab
Office	Steel Frame		Re-Conc.
Hotel		Roofing	
Factory	Ex'ty Walls	Shingle X	
Warehouse	Clap.	Slate	Heating
Barn	Shingle X	Tile	Fireplace X
Garage X	Stucco	Gravel	Stove X
	Paper	Paper	Hot Air X
	Com. Brick	Iron	Hot Water X
	Stone	Asbestos	Steam
	Concrete		Oil Burner
	Post		Mech. Stoker
	Insulation	Partition	Plumbing
	Lighting	Plaster X	Water Sys. X
	Elec. X	Wall'd	Sink X
	Lamps		Closet X
	Home Sys.		Hot Water X
			Bath X
			Set Tub X
			Cesspool
			Septic T. X
			elec. pump

Rooms	1	2	3	4	5
	5	2			
Road - Dirt	<input type="checkbox"/>	Gravel	<input type="checkbox"/>	Surfaced	<input checked="" type="checkbox"/>
Retrig. Elevator		Sprinkler		Fire Escape	

APRIL 11, 1910

BOOK 855 PAGE 195

Pair condition. 1 1/2 story.

A certain lot or parcel of land with the buildings thereon, situated in said Bridgton and being my present Homestead Premises and also a wood-lot and being the same real estate conveyed to me by Charles S. Wiley by deed Oct. 12, 1907, recorded in Cumbl. Rec. of deeds, book 814, page 255, to which deed and deeds therein referred to and their referents may be had.

This property as recorded by Charles S. Wiley of Fryeburg in book 716 page 420 dated Aug. 25, 1899. Certain real estate situated in said town of Bridgton called Pumpkin Valley being my late homestead farm lying on the northerly and southerly sides of the road leading from Bridgton to Fryeburg; the northerly portion of said farm on which stand the buildings; bounded as follows:- southerly by said Bridgton-Fryeburg road; easterly by land of Luther Douglass as the wall now stands dividing his homestead premises from the land now being

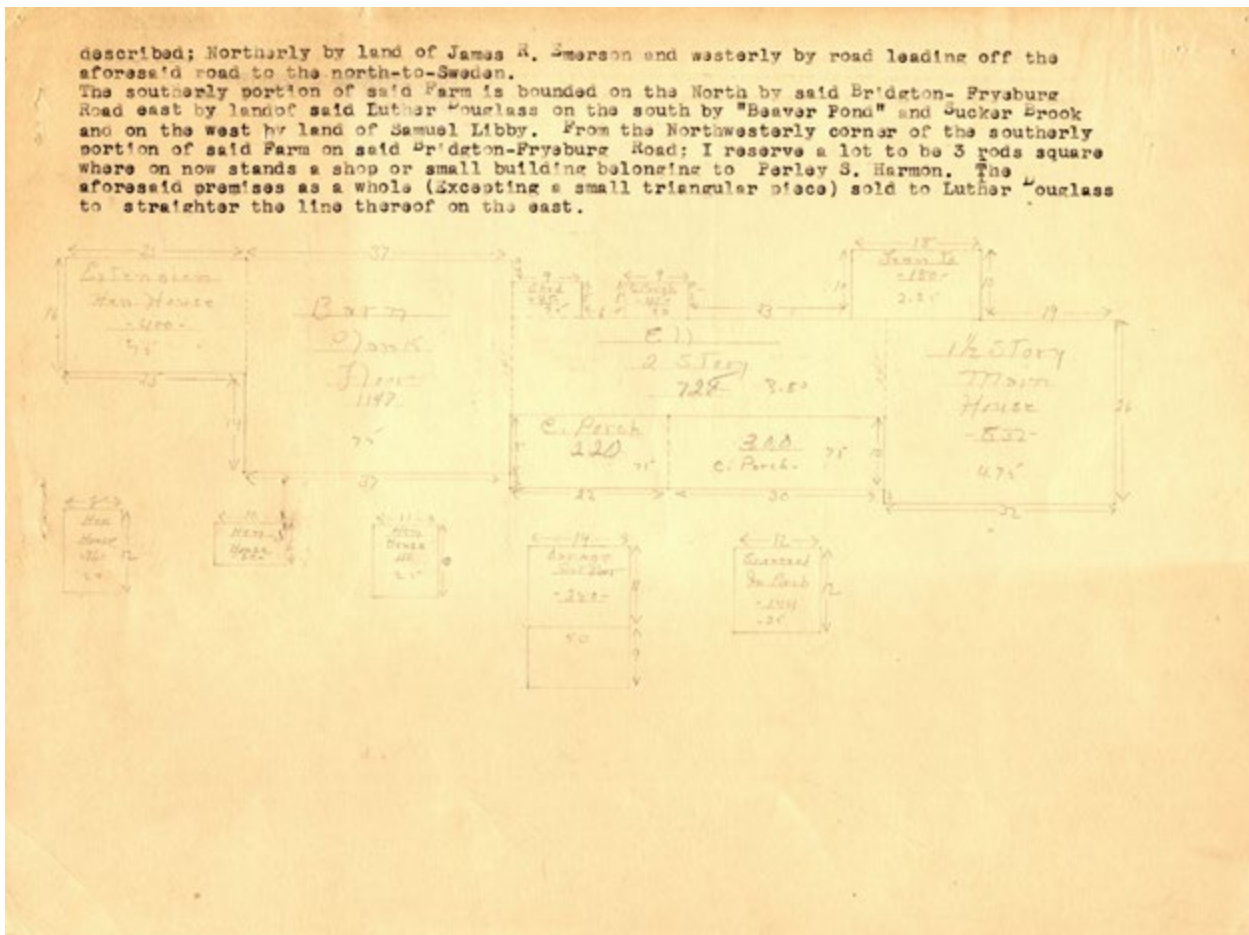

Collections of Bridgton Historical Society



Contributed to Maine Memory Network by Bridgton Historical Society

MMN # 102638
Date: 1930s Bridgton Tax Records
Location: 2686 West Bridgton, ca. 1938
Owner: Clayton L. Ames & J. Belle Ames
Use: Residential