

RANGE	LOT	OWNER	ADDRESS	
13	8	Everett Brown	18 Bennett St-Bridgton	9

TOWN OF BRIDGTON, MAINE			BUILDING			
ASSESSORS' DEPARTMENT			Class	Construction	Roof	Floors
LAND			House	Frame X	Flat	Common X & C
Frontage	Depth	Area	Single	Brick	Hip	Hardwood
115-105	167-168	18,425	Double	Tile	Gable X	Composition
COMPUTATIONS			Apartment	Block		Tile
Area	Unit	Value	Store	Mill		Conc. Slabs
LAND VALUE			Office	Steel Frame		Re-Conc.
BUILDING VALUE			Factory	Ext'r Walls	Roofing	Heating
TOTAL			Warehouse X	Clap.	Shingle	Fireplace
			Barn	Siding metal	Slate	Stove
			Garage	Shingle	Tile	Hot Air
				Stucco	Gravel	Hot Water
				Paper	Paper	Steam
				Com. Brick	Iron	Oil Burner
				Stone	Asbestos	Mech. Stoker
				Insulation	Steel	Plumbing
				Lighting	Partition	Water Sys. X
				Elec. X	Plaster	Sink X
				Lamps	Wall'b'd	Closet
				Home Sys.		Hot Water
						Bath
						Set Tub
						Cesspool
						Septic T.

DESCRIPTION OF PROPERTY: 1 story warehouse-good condition

BOOK PAGE

"A certain lot or parcel of land with the buildings thereon situate in said Bridgton, a part of lot numbered seven in the thirteenth range of said town's lots lying on the easterly side of Bennett, Street, so called, in said Bridgton Center Village, bounded as follows:- Commence on said side of said street at the center of a large rock which is the northwesterly corner thereon of the old Isaac Chase homestead lot; thence run North twenty-nine and one fourth degrees West by said street a distance of about sixty-three feet to an iron pipe; thence north sixty-one degrees East nine rods and nineteen links to an iron pipe driven in a ditch supposed to be on line of land formerly owned by Lucy A. Berry; thence southeasterly by said Berry land to a corner of said Isaac Chase lot; thence westerly by said Chase lot to the corner thereof begun at, to wit, said large rock. Being the same premises conveyed to the Grantors by Frank L. Wilson by deed dated April 26, 1928 and recorded in the Cumberland Registry of Deeds, Book 1290, Page 285. Also a certain lot or parcel of land adjoining the above described parcel, situate in said Bridgton and in Bridgton Center Village and on the Northeasterly side of Bennett Street, bounded and described as follows: Commence on said Northeasterly side of said Bennett Street, and at the Southwesterly corner thereon of the above described premises, said corner being formerly the corner



RANGE	LOT	OWNER	ADDRESS	
13	8	Everett Brown (dead)	Bennett Street, Bridgton, Maine	9

TOWN OF BRIDGTON, MAINE			BUILDING			
ASSESSORS' DEPARTMENT			Class	Construction	Roof	Floors
LAND			House	Frame	Flat	Common
Frontage	Depth	Area	Single	Brick	Hip	Hardwood
COMPUTATIONS			Double	Tile	Gable	Composition
Area	Unit	Value	Apartment	Block		Tile
LAND VALUE			Store	Mill		Conc. Slabs
BUILDING VALUE			Office	Steel Frame		Re-Conc.
TOTAL			Factory	Ext'r Walls	Roofing	Heating
			Warehouse	Clap.	Shingle	Fireplace
			Barn	Siding	Slate	Stove
			Garage	Shingle	Tile	Hot Air
				Stucco	Gravel	Hot Water
				Paper	Paper	Steam
				Com. Brick	Iron	Oil Burner
				Stone	Asbestos	Mech. Stoker
				Insulation	Steel	Plumbing
				Lighting	Partition	Water Sys.
				Elec.	Plaster	Sink
				Lamps	Wall'b'd	Closet
				Home Sys.		Hot Water
						Bath
						Set Tub
						Cesspool
						Septic T.

DESCRIPTION OF PROPERTY: # 2-----

BOOK PAGE

of land owned by the late Lyman Bradstreet, thence run Southeasterly by said Street sixty (60) feet; thence Northeasterly and parallel with, and sixty (60) feet Southeasterly of the present Southeasterly line of the above described parcel (old Bradstreet-line) to land of Laforest Woolley, formerly owned by Ellen M. Bangs; thence Northwesterly and by said last named Woolley-Bangs land, sixty (60) feet, to the Southeasterly corner of the above described premises; thence run Southwesterly and by the above described parcel (old Bradstreet-line) to the point and bound on said Bennett Street begun at. Being the same premises conveyed to the Grantors by Charles A. Berry by deed dated November 13, 1928 and recorded in said Registry book 1307, page 494."

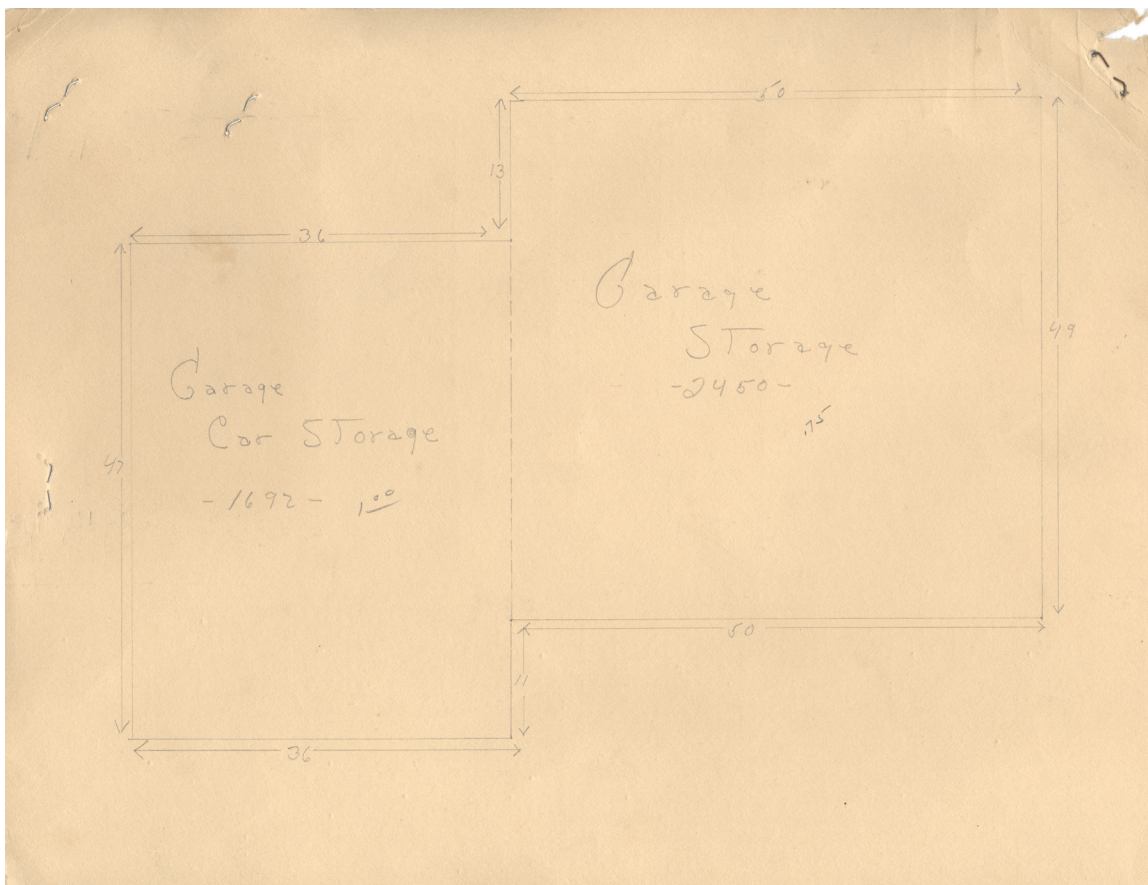

Contributed to Maine Memory Network by Bridgton Historical Society

MMN # 101352
Date: 1930s Bridgton Tax Records
Location: 10 Bennett Street, Bridgton
Owner: Everett Brown
Use: Warehouse