

|             |            |                                   |   |     |
|-------------|------------|-----------------------------------|---|-----|
| RANGE<br>13 | LOT<br>7-8 | OWNER<br>Harold O. Easton (Store) | ADDRESS<br>8 Flint Street, Bridgton, Maine. | 139 |
|-------------|------------|-----------------------------------|---|-----|

| TOWN OF BRIDGTON, MAINE                         |       |       | BUILDING |  |
|---|-------|-------|----------|--|
| ASSESSORS' DEPARTMENT                           |       |       |          |  |
| LAND  |       |       |          |  |
| Frontage  | Depth | Area  |          |  |
| on card with Ranges                             |       |       |          |  |
| COMPUTATIONS                                    |       |       |          |  |
| Area  | Unit  | Value |          |  |
| LAND VALUE                                      |       |       |          |  |
| BUILDING VALUE STORE 640 sq. ft. X 25 = 1440.00 |       |       |          |  |
| Discount 70% 1296.00                            |       |       |          |  |
| Educ. FIRE PLACE 125                            |       |       |          |  |
| TOTAL " No. Plumbing 100. 225.00                |       |       |          |  |
| 1071.00   |       |       |          |  |
| Value 535                                       |       |       |          |  |

| Class                                | Construction                    | Roof   | Floors       |
|--------------------------------------|---------------------------------|--|--------------|
| House                                | Frame X                         | Flat   | Common X     |
| Single                               | Brick                           | Hip  | Hardwood     |
| Double                               | Tile                            | Gable X                                      | Composition  |
| Apartment                            | Block                           |  | Tile         |
| Store X                              | Mill                            |  | Conc. Slabs  |
| Office                               | Steel Frame                     |  | Re-Conc.     |
| Hotel                                |                                 | Roofing                                      |              |
| Factory                              | Ext'r Walls                     | Shingle                                      | Heating      |
| Warehouse                            | Clap. X                         | Slate  | Fireplace    |
| Barn                                 | Siding                          | Tile   | Stove 1      |
| Garage                               | Shingle                         | Gravel                                       | Hot Air      |
|                                      | Stucco                          | Paper X                                      | Hot Water    |
|                                      | Paper                           | Iron   | Steam        |
|                                      | Com. Brick                      | Asbestos                                     |              |
| Foundation                           | Stone                           |  | Oil Burner   |
| Stone                                | Insulation                      |  | Mech. Stoker |
| Brick                                |                                 | Partition                                    |              |
| Concrete                             |                                 | Plaster                                      | Plumbing     |
| Post X                               |                                 | Wall'd                                       | Water Sys.   |
|                                      | Lighting                        | sheathing                                    | Sink         |
| Basement                             | Elec. X                         |  | Closet no    |
| no                                   | Lamps                           |  | Hot Water    |
|                                      | Home Sys.                       |  | Bath         |
| Rooms                                |                                 |  | Set Tub      |
| 1                                    |                                 |  | Cesspool     |
| 1                                    |                                 |  | Septic T.    |
|                                      |                                 |  |              |
| Road - Dirt <input type="checkbox"/> | Gravel <input type="checkbox"/> | Surfaced <input checked="" type="checkbox"/> |              |
| Refrig.                              | Sprinkler                       |  |              |
| Elevator                             | Fire Escape                     |  |              |

DESCRIPTION OF PROPERTY One Story in good condition. BOOK 541 PAGE 103 Oct. 14, 1887  
 Annie E. Easton :----- Beginning at the point of intersection of Iredale Street, so called, with the  
 North Bridgton Road thence running Westerly by said Iredale Street, to land of Orin B. Thompson, thence  
 Southerly by said Thompson land to land to Jeff C. Gallison and wife, thence Easterly, Northerly, and  
 Easterly by said Gallison land to the aforesaid North- Bridgton road thence Northerly by said North  
 Bridgton road to the place of beginning and bound first mentioned.





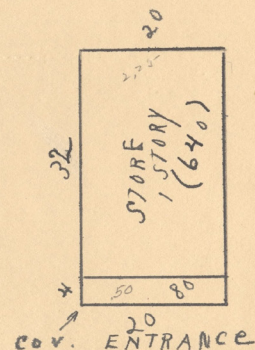

Contributed to Maine Memory Network by Bridgton Historical Society

MMN # 101229  
Date: 1930s Bridgton Tax Records  
Location: 8 Flint Street, Bridgton  
Owner: Harold O. Easton  
Use: Commercial