

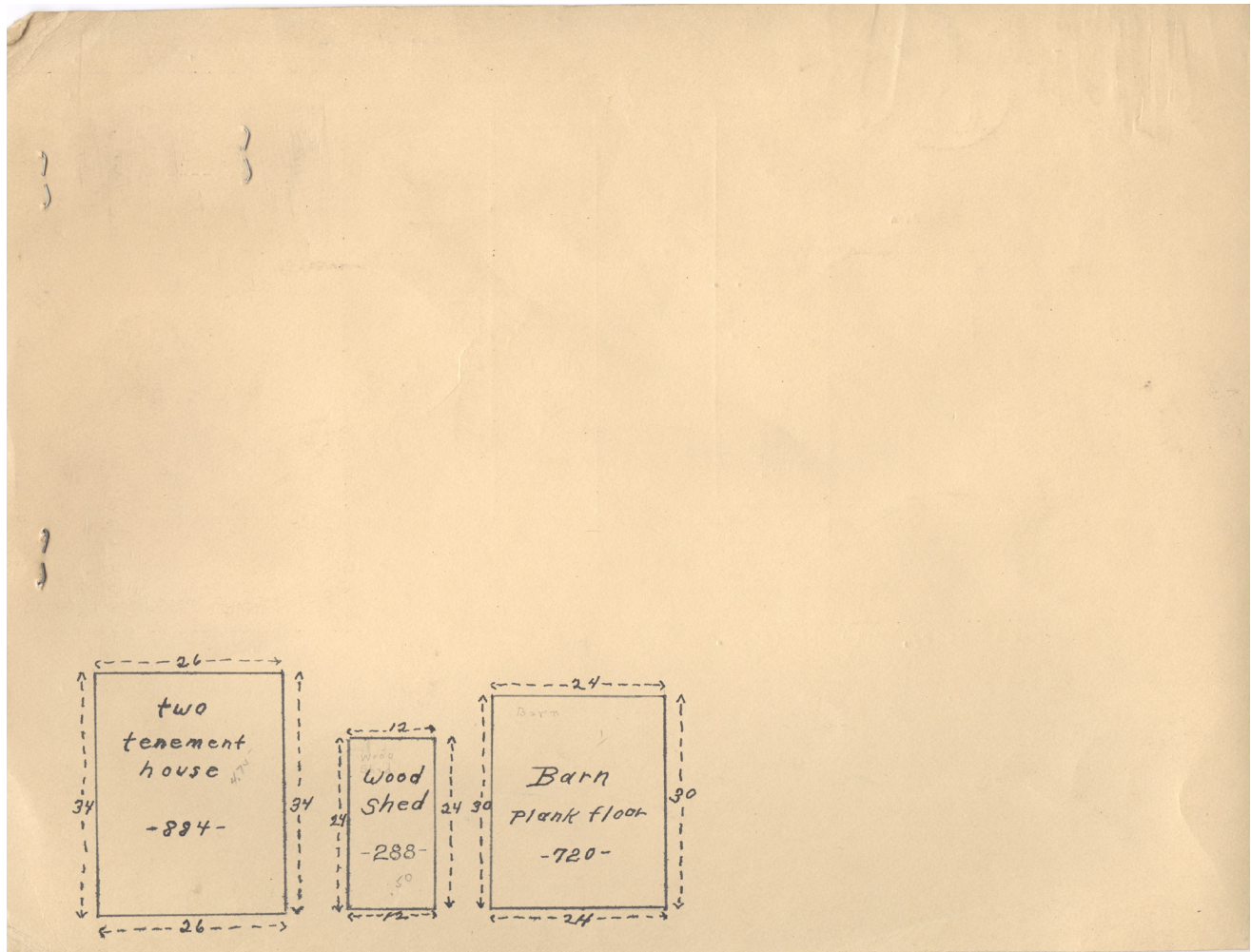

RANGE	LOT	OWNER	ADDRESS
14	7-8	W. E. & Mabel V. Littlehale Gertie B. Chadbourne	17 & 19 Flint Street, Bridgton, Maine

TOWN OF BRIDGTON, MAINE		BUILDING	
ASSESSORS' DEPARTMENT			
LAND			
Frontage	Depth	Area	
71	127		
COMPUTATIONS			
Area	Unit	Value	
LAND VALUE taxed for 1/4 here in Val 1300			
BUILDING VALUE House 8840g 1/4 4299 BARN 720 1/4 144 Wood Shed 288 1/4 144			
TOTAL REPLACEMENT VALUE 5163			
Discount 50% 2586			
Deduct N. HEAT 200 2386			
No Plumb 150 2236			
Value 1118			
DESCRIPTION OF PROPERTY 1 1/2 Story, Fair Condition.		BOOK 1457 2198	PAGE 452 272 Jan. 15, 1935
A certain lot or parcel of land with the buildings thereon and being the homestead premises of the said Edward W. Wallace at the time of his decease; situated in Bridgton Center Village in said Bridgton and on the Easterly side of Flint St. bounded Northerly by land of Luella Carson, Easterly by land of said Carson and land of Virgil Burnell, Southerly by homestead premises of Daniel Norton and Westerly by said Flint Street.			





Contributed to Maine Memory Network by Bridgton Historical Society

MMN # 100690

Date: 1930s Bridgton Tax Records

Location: 17 & 19 Flint Street, Bridgton

Owner: Carrie B. Chadbourne

Use: Residential