

RANGE	LOT	OWNER	ADDRESS
13	7-8	Harold O. Easton (Store)	8 Flint Street, Bridgton, Maine.

139

TOWN OF BRIDGTON, MAINE

ASSESSORS' DEPARTMENT

LAND		
Frontage	Depth	Area
90' card with house.		

COMPUTATIONS		
Area	Unit	Value
LAND VALUE		
BUILDING VALUE STORE 640 sq ft x 2 ²⁵ 1440.00		
Discount 10% 1296.00		
Deduct FIRE PLACE 125		
TOTAL " No. Plumbing 100. 225. 1071.00		

VALUE 535

BUILDING			
Class	Construction	Roof	Floors
House	Frame <input checked="" type="checkbox"/>	Flat	Common <input checked="" type="checkbox"/>
Single	Brick	Hip	Hardwood
Double	Tile	Gable <input checked="" type="checkbox"/>	Composition
Apartment	Block		Tile
Store <input checked="" type="checkbox"/>	Mill		Conc. Slabs
Office	Steel Frame		Re-Conc.
Hotel		Roofing	
Factory	Ext'r Walls	Shingle	Heating
Warehouse	Clap. <input checked="" type="checkbox"/>	Slate	Fireplace
Barn	Siding	Tile	Stove
Garage	Shingle	Gravel	Hot Air
	Stucco	Paper <input checked="" type="checkbox"/>	Hot Water
		Iron	Steam
		Asbestos	
Foundation	Paper	Partition	Oil Burner
Stone	Com. Brick	Plaster	Mech. Stoker
Brick	Stone	Wallb'd	Plumbing
Concrete	Insulation	sheathing	Water Sys.
Post <input checked="" type="checkbox"/>			Sink
	Lighting		Closet no
Basement	Elec. <input checked="" type="checkbox"/>		Hot Water
	Lamps		Bath
	Home Sys.		Set Tub
Rooms	1 2 3 4 5		Cesspool
	1		Septic T.
Road - Dirt <input type="checkbox"/> Gravel <input type="checkbox"/> Surfaced <input checked="" type="checkbox"/>			
Refrigerator	Sprinkler		
Elevator	Fire Escape		



DESCRIPTION OF PROPERTY One Story in good condition. BOOK 541 PAGE 103 Oct. 14, 1887
Annie E. Easton :----- Beginning at the point of intersection of Iredale Street, so called, with the North Bridgton Road thence running Westerly by said Iredale Street, to land of Orin B. Thompson, thence Southerly by said Thompson land to land to Jeff C. Gallison and wife, thence Easterly, Northerly, and Easterly by said Gallison land to the aforesaid North- Bridgton road thence Northerly by said North Bridgton road to the place of beginning and bound first mentioned.

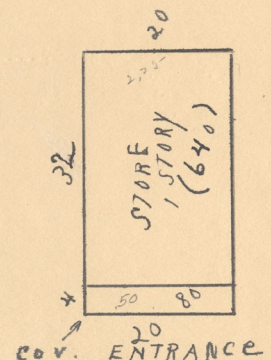



Contributed to Maine Memory Network by Bridgton Historical Society

MMN # 100688

Date: 1930s Bridgton Tax Records

Location: 8 Flint Street, Bridgton

Owner: Harold O. Easton

Use: Commerical