

RANGE 14	LOT 7	OWNER High School Building	ADDRESS Gibbs Ave-Bridgton, Me.	162
-------------	----------	-------------------------------	------------------------------------	-----

TOWN OF BRIDGTON, MAINE
ASSESSORS' DEPARTMENT

LAND

Frontage	Depth	Area

COMPUTATIONS

Area	Unit	Value

LAND VALUE

BUILDING VALUE

TOTAL

BUILDING

Class	Construction	Roof	Floors
House	Frame	Flat	Common
Single	Brick	Hip	Hardwood
Double	Tile	Gable	Composition
Apartment	Block		Tile
Store	Mill		Conc. Slabs
Office	Steel Frame	Roofing	Re-Conc.
Hotel			
Factory	Extr Walls	Shingle	Heating
Warehouse	Clap.	Slate	Fireplace
Barn	Siding	Tile	Stove
Garage	Shingle	Gravel	Hot Air
	Stucco	Paper	Hot Water
	Paper	Iron	Steam
		Asbestos	
Foundation			Oil Burner
Stone	Com. Brick		Mech. Stoker
Brick	Stone	Partition	
Concrete	Insulation	Plaster	Plumbing
Post		Wall'b'd	
	Lighting		Water Sys.
Basement	Elec.		Sink
	Lamps		Closet
	Home Sys.		Hot Water
			Bath
			Set Tub
			Cesspool
			Septic T.

Rooms 1 2 3 4 5

Road - Dirt ☐ Gravel ☐ Surfaced ☐

Refrig. Sprinkler

Elevator Fire Escape

DESCRIPTION OF PROPERTY

April 26, 1897

BOOK 648

PAGE 358

A certain lot or parcel of land situated in said Town of Bridgton and in Bridgton Center Village and on the southerly side of the Street leading from Main Street in said Village past the house of William Wallace Hazen to the High School Building Lot and laying next easterly and adjacent to same High School Building lot bounded and described as follows, to wit: Commence at the northwesterly corner on said school street of an eight foot strip of land this day deeded said Hazen by myself said Lucy A. Berry, marked by an iron pipe; thence westerly viz: south sixty-eight degrees west fifty two feet to an iron pipe supposed to be driven at the point of intersection of the easterly side line of said School Lot with the southerly side line of said Street, said last corner running by said School Street; thence by said School lot running south four degrees and thirty minutes west to Depot Street; thence southerly by said Depot Street to the southwesterly corner of said eight foot strip this day deeded as aforesaid, thence north about fifteen degrees west by the westerly side line of



said eight-foot strip to School Street aforesaid and the point thereon of commencement and bound first mentioned, meaning to convey all the land which I own laying between said School Building Lot and land of said Hazen on the southerly side of said School Street.

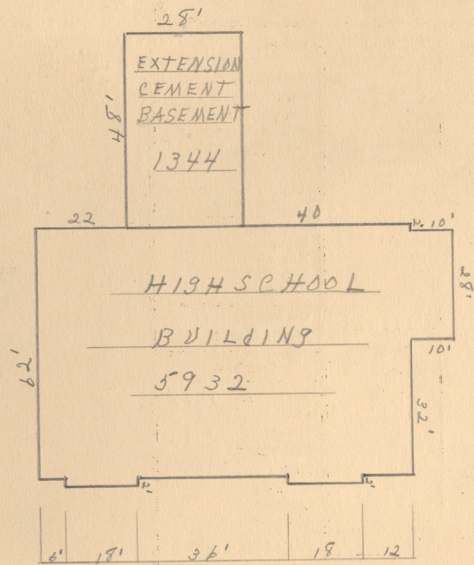



Contributed to Maine Memory Network by Bridgton Historical Society

MMN # 100672

Date: 1930s Bridgton Tax Records

Location: Bridgton High School, Gibbs Avenue

Owner: Town of Bridgton

Use: Municipal