

RANGE 14	LOT 8	OWNER Mrs Alice Sargent	ADDRESS 33 Flint Street, Bridgton, Maine.
-------------	----------	----------------------------	--

TOWN OF BRIDGTON, MAINE
ASSESSORS' DEPARTMENT

LAND

Frontage	Depth	Area
92	132	

COMPUTATIONS

Area	Unit	Value
LAND VALUE Taxed for 1/3 acre in 17.1 foot		
BUILDING VALUE House 702 sq ft x \$4.50 = 3334.50		
ELL 968 sq ft x \$2.25 = 2178.		
Porch 130 sq ft x \$7.50 = 975.00		
TOTAL LEANTO 120 sq ft x \$5.00 = 600.00		
GARAGE 225 sq ft x \$5.00 = 1125.00		
REPLACEMENT VALUE - 5682.00		
DISCOUNT 60% 2223.00		
Deduct No Heat 200		
No Plumb 150		
VALUE 960		

BUILDING

Class	Construction	Roof	Floors
House <input checked="" type="checkbox"/>	Frame <input checked="" type="checkbox"/>	Flat	Common <input checked="" type="checkbox"/>
Single <input checked="" type="checkbox"/>	Brick	Hip	Hardwood
Double	Tile	Gable <input checked="" type="checkbox"/>	Composition
Apartment	Block		Tile
Store	Mill		Conc. Slabs
Office	Steel Frame		Re-Conc.
Hotel			
Factory			
Warehouse			
Barn			
Garage <input checked="" type="checkbox"/>			

Ex't'r Walls	Roofing	Heating
Clap. <input checked="" type="checkbox"/>	Shingle <input checked="" type="checkbox"/>	Slate
Siding	Tile	Fireplace
Shingle	Gravel	Stove <input checked="" type="checkbox"/>
Stucco	Paper	Hot Air
Paper	Iron	Hot Water
Comm. Brick	Asbestos	Steam
Stone	M.H. Steel	Oil Burner
Concrete		Mech. Stoker
Post		

Foundation	Lighting	Partition
Stone <input checked="" type="checkbox"/>	Elec. <input checked="" type="checkbox"/>	Plaster
Brick	Batts	Wall/b'd <input checked="" type="checkbox"/>
Concrete	Home Sys.	
Insulation		

Basement	Rooms	Road - Dirt <input type="checkbox"/> Gravel <input type="checkbox"/> Surfaced <input checked="" type="checkbox"/>
dirt floor	1 2 3 4 5	
main house	5 3	

Refrigerator	Sprinkler	Natural drain
Elevator	Fire Escape	

DESCRIPTION OF PROPERTY 1st Story -- Fair Condition,
1 car garage-- poor condition..
Alice M. Sargent;-- Northerly by wild land of Maurice Hamblen; Easterly by house lot of Harold G. Graffam; Southerly by house lot of Caroline Woolley and Westerly by said Flint Street Carolyn

BOOK PAGE

and having a frontage on said Flint Street of six and one-half (6½) rods more or less.
Deed dated Oct. 24th. 1936, and unrecorded as yet.

Book 1590, page 395: A certain lot or parcel of land with the buildings thereon, being a part of lot #7 in the 15th Range of lots in said Bridgton, and bounded and described as follows: Commence on the easterly side of Flint Street so called at the southwesterly corner of land of Maurice Hamblen; thence easterly 7 and 7/8 rods more or less by the southerly line of said Hamblen land to an iron pipe driven in the ground near a hard pine tree, the post marking the northeasterly corner of the premises hereby conveyed and the northwesterly corner of lot of Myrtle Graffam; thence southerly by land of said Graffam and continuing on the same course and in a straight line 6 and 5/8 rods more or less, to an iron post driven in the ground by a stone wall on line of land of Caroline Woolley; thence westerly by the

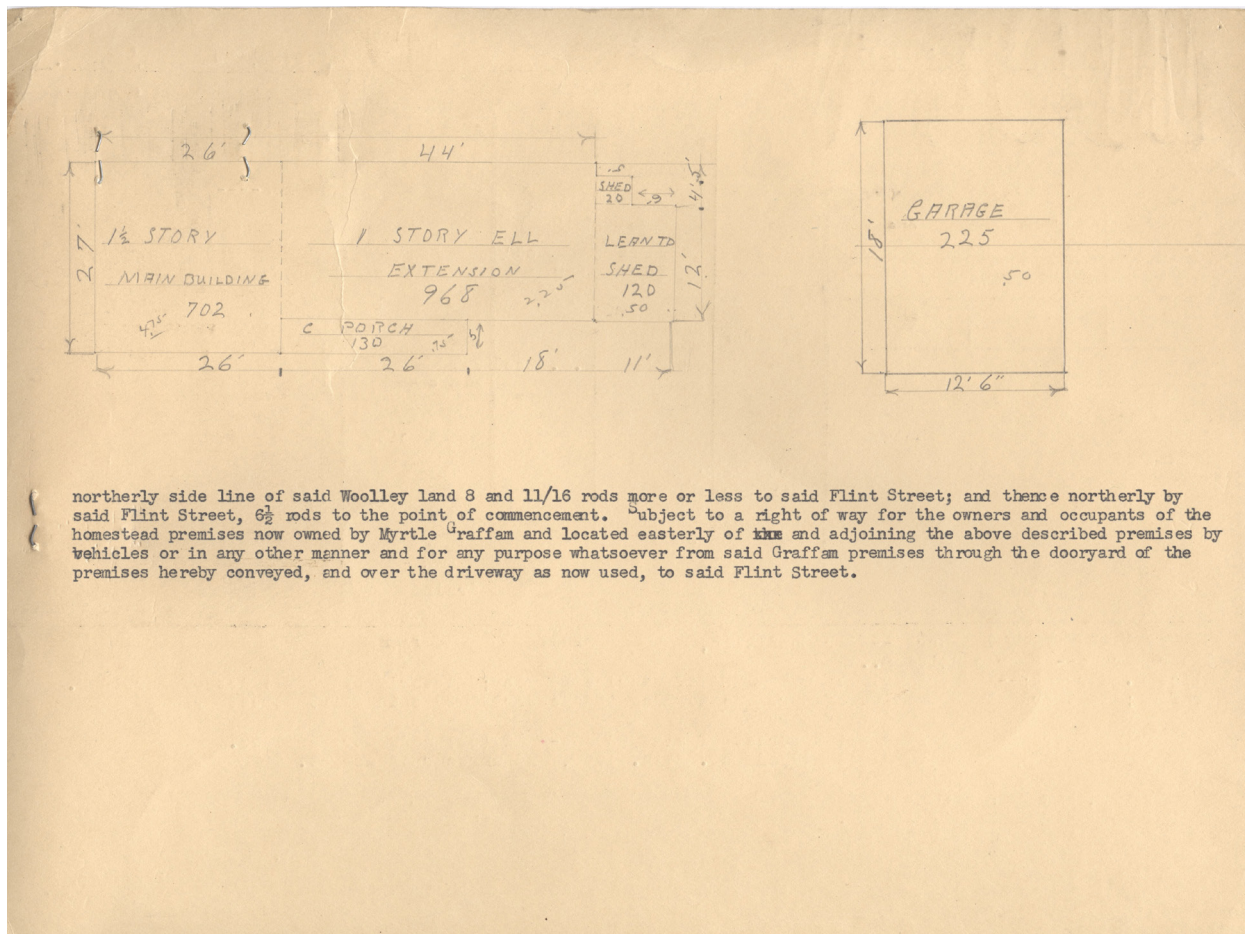



Contributed to Maine Memory Network by Bridgton Historical Society

MMN # 101242
Date: 1930s Bridgton Tax Records
Location: 33 Flint Street, Bridgton
Owner: Alice Sargent
Use: Residential